

## Седёлка РР двухсторонняя

**Материал:** корпус и гайка - УФ-стойкий полипропилен (PP);  
 зажимная часть - полиацеталь (POM);  
 уплотнение - резина, пригодная для питьевой воды

**Стандарты:** производятся в соответствии со стандартами TS ISO 17885

**Рабочее давление:** 16 бар при 20°C и 10 бар при 40°C (для воды)

**Производство:** PIMTAŞ-Турция

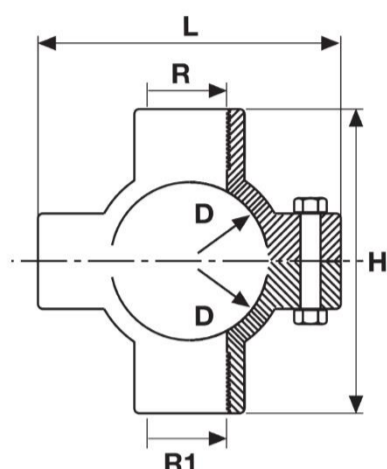

Артикул	Размер	PN	Кол-во в коробке
ex529 11 03202020 2	32 x 1/2"	16	300
ex529 11 03202525 2	32 x 3/4"	16	200
ex529 11 03203232 2	32 x 1"	16	125
ex529 11 04002020 2	40 x 1/2"	16	175
ex529 11 04002525 2	40 x 3/4"	16	150
ex529 11 04003232 2	40 x 1"	16	80
ex529 11 05002020 2	50 x 1/2"	16	140
ex529 11 05002525 2	50 x 3/4"	16	120
ex529 11 05003232 2	50 x 1"	16	110
ex529 11 05004040 2	50 x 1 1/4"	16	30
ex529 11 05005050 2	50 x 1 1/2"	16	30
ex529 11 06302020 2	63 x 1/2"	16	80
ex529 11 06302525 2	63 x 3/4"	16	70
ex529 11 06303232 2	63 x 1"	16	70
ex529 11 06304040 2	63 x 1 1/4"	16	50
ex529 11 06305050 2	63 x 1 1/2"	16	50
ex529 11 07502020 2	75 x 1/2"	16	60
ex529 11 07502525 2	75 x 3/4"	16	60
ex529 11 07503232 2	75 x 1"	16	60
ex529 11 07504040 2	75 x 1 1/4"	16	40
ex529 11 07505050 2	75 x 1 1/2"	16	40
ex529 11 07506363 2	75 x 2"	16	30
ex529 11 09002020 2	90 x 1/2"	16	80
ex529 11 09002525 2	90 x 3/4"	16	55
ex529 11 09003232 2	90 x 1"	16	55
ex529 11 09004040 2	90 x 1 1/4"	16	40
ex529 11 09005050 2	90 x 1 1/2"	16	35
ex529 11 09006363 2	90 x 2"	16	30
ex529 11 11002020 2	110 x 1/2"	16	35
ex529 11 11002525 2	110 x 3/4"	16	50
ex529 11 11003232 2	110 x 1"	16	50
ex529 11 11004040 2	110 x 1 1/4"	16	35
ex529 11 11005050 2	110 x 1 1/2"	16	35
ex529 11 11006363 2	110 x 2"	16	30
ex529 11 12502020 2	125 x 1/2"	16	10
ex529 11 12502525 2	125 x 3/4"	16	36
ex529 11 12503232 2	125 x 1"	16	36
ex529 11 12504040 2	125 x 1 1/4"	16	32
ex529 11 12505050 2	125 x 1 1/2"	16	32
ex529 11 12506363 2	125 x 2"	16	32
ex529 11 14002020 2	140 x 1/2"	16	6
ex529 11 14002525 2	140 x 3/4"	16	24
ex529 11 14003232 2	140 x 1"	16	24
ex529 11 14004040 2	140 x 1 1/4"	16	24
ex529 11 14005050 2	140 x 1 1/2"	16	24
ex529 11 14006363 2	140 x 2"	16	22
ex529 11 16002020 2	160 x 1/2"	16	6
ex529 11 16002525 2	160 x 3/4"	16	16
ex529 11 16003232 2	160 x 1"	16	16
ex529 11 16004040 2	160 x 1 1/4"	16	14
ex529 11 16005050 2	160 x 1 1/2"	16	14
ex529 11 16006363 2	160 x 2"	16	14
ex529 11 20002525 2	200 x 3/4"	16	
ex529 11 20003232 2	200 x 1"	16	
ex529 11 20004040 2	200 x 1 1/4"	16	
ex529 11 20005050 2	200 x 1 1/2"	16	8
ex529 11 20006363 2	200 x 2"	16	8

D	R*R1	L	H
32	1/2"	54	52
32	3/4"	54	82
32	1"	78	82
40	1/2"	78	82
40	3/4"	80	88
40	1"	80	88
50	1/2"	80	88
50	3/4"	84	101
50	1"	84	101
50	1 1/4"	84	101
50	1 1/2"	98	114
63	1/2"	98	114
63	3/4"	98	114
63	1"	98	114
63	1 1/4"	98	114
63	1 1/2"	117	117
75	1/2"	117	118
75	3/4"	117	129
75	1"	117	129
75	1 1/4"	117	129
75	1 1/2"	117	129
75	2"	117	111
90	1/2"	128	131
90	3/4"	128	134
90	1"	128	141
90	1 1/4"	128	143
90	1 1/2"	128	143
90	2"	128	146
110	1/2"	146	173
110	3/4"	146	173
110	1"	146	173
110	1 1/4"	146	173
110	1 1/2"	146	173
110	2"	146	173
125	1/2"	166	193
125	3/4"	166	193
125	1"	166	193
125	1 1/4"	166	193
125	1 1/2"	166	193
125	2"	166	193
140	1/2"	178	216
140	3/4"	178	216
140	1"	178	216
140	1 1/4"	178	216
140	1 1/2"	178	216
140	2"	178	216
160	1/2"	216	230
160	3/4"	216	230
160	1"	216	230
160	1 1/4"	216	230
160	1 1/2"	216	230
160	2"	216	230
200	3/4"		
200	1"		
200	1 1/4"		
200	1 1/2"	262	230
200	2"	262	230